



The **SS12<sup>CONNECT</sup>** is a new variant of miniature photocell from Lucy Zodion. Its pioneering push and click technology creates a faster improved installation.

**SS12<sup>CONNECT</sup>**

**Push, Click, Connect**

The **SS12<sup>CONNECT</sup>** is a fully certified connector system, simplifying existing systems with no new installation processes – making adoption quick and easy.

The range includes heavy-duty switching versions and units designed for long-life or operation at high temperatures.

The **SS12<sup>CONNECT</sup>** is a new variant of miniature photocell from Lucy Zodion.

- Its pioneering push and click technology creates a faster, improved installation.
- Maintenance and upgrade processes are simplified and more efficient, saving both time and money.
- The **SS12<sup>CONNECT</sup>** is a fully certified connector system, simplifying existing systems with no new installation processes – making adoption quick and easy.

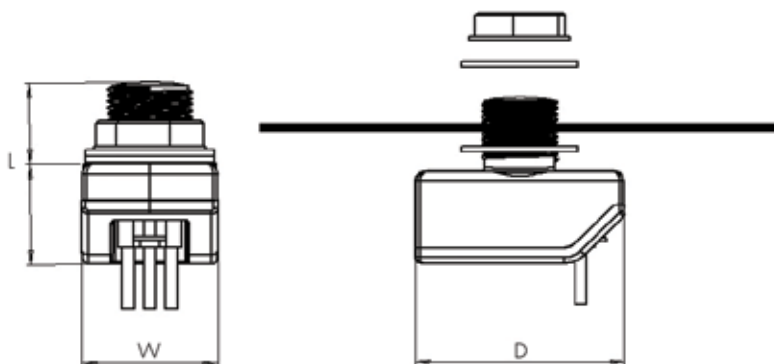

## Technical specifications

PCB	Through hole plated PCB for increased mechanical durability
Surge	2kAV to EN61000-4-5
Materials	High impact, UV stable, UL94 V-2 flame retardant impact resistant polycarbonate
Operational Voltage Range	198V – 264V
Operational Frequency Range	50/60Hz
Power Consumption	<250mW
Switching Mechanism	Electromagnetic relay
IP Rating	IP66 installed (Potted version available)
Umsug charge code:	94 0001 1000 100* *for further reference: <a href="http://www.Elexon.co.uk">www.Elexon.co.uk</a>

## Connections

Device connections	0.75mm <sup>2</sup> tri-rated cable - Live in, Live out. 0.5mm <sup>2</sup> tri-rated cable - neutral Connected with push fitting
--------------------	---

## Dimensions

	Size (mm)
Body length (L)	53.5
Body width (W)	31.5
Body depth (D)	44

Lucy Zodion Ltd  
Station Road  
Sowerby Bridge  
West Yorkshire  
HX6 3AF  
T +44 (0)1422 317 337  
[sales@lucyzodion.com](mailto:sales@lucyzodion.com)

[www.lucyzodion.com](http://www.lucyzodion.com)



BSS12C-001-V1